

DELIVERING SUMMER 2023

**70,050 SF
AVAILABLE**



1200 Oakdale Road
GRAND PRAIRIE, TX 75050

OWNED BY:

 **Alliuz**[®]

LUKE DAVIS
214.267.0420
ldavis@streamrealty.com

CHARLES BREWER
214.560.2960
charles.brewer@StreamRealty.com

LEASED BY:

STREAM

1200 Oakdale Road

GRAND PRAIRIE, TX 75050

BUILDING DETAILS

- 70,050 SF Available
- 1,500 SF Spec Office
- 28' Clear Height
- 44 Car Parks
- 7 Dock High (9' x 10')
Expandable to 24
- 2 Ramps (12' x 14')
- Ability to fully fence and secure
- ESFR Sprinkler System

PROPERTY FEATURES

- Access to SH-161 + I-30
- Close proximity to DFW Airport
- Centrally located in DFW metroplex

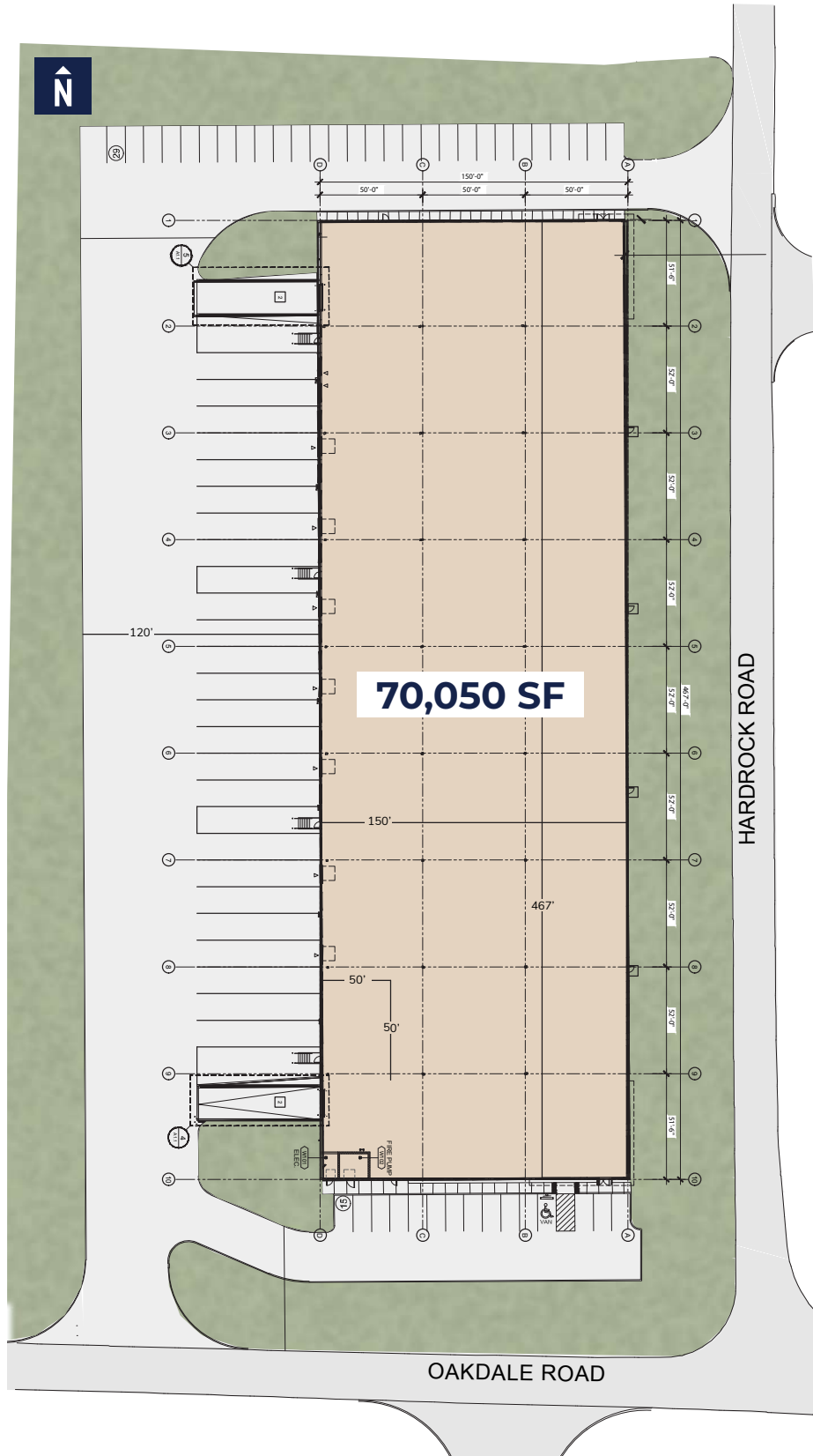
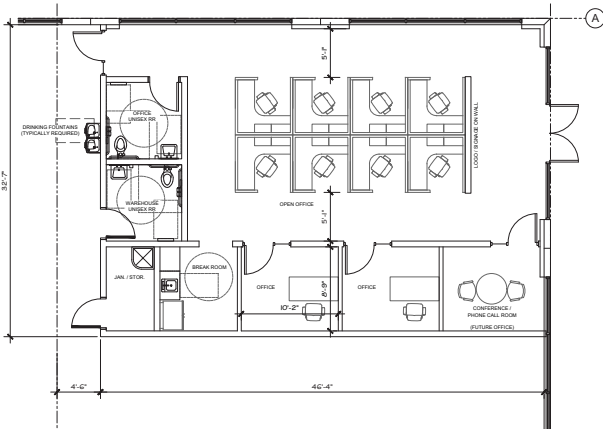

LUKE DAVIS

214.267.0420

ldavis@streamrealty.com

CHARLES BREWER

214.560.2960

charles.brewer@StreamRealty.com



1200 Oakdale Road

GRAND PRAIRIE, TX 75050



LOCATION HIGHLIGHTS

DALLAS CBD:	16 MILES
FORT WORTH CBD:	20 MILES
DFW AIRPORT:	6 MILES
STATE HIGHWAY 161:	.1 MILES
INTERSTATE 30:	3 MILES



LUKE DAVIS

214.267.0420

ldavis@streamrealty.com

CHARLES BREWER

214.560.2960

charles.brewer@StreamRealty.com



1200 Oakdale Road

GRAND PRAIRIE, TX 75050



LUKE DAVIS

214.267.0420

ldavis@streamrealty.com

CHARLES BREWER

214.560.2960

charles.brewer@StreamRealty.com

